User Guide

Nokia Asha 501 Dual SIM

NOKIA

Psst...

This guide isn't all there is...

For info on Nokia Service terms and Privacy policy, go to www.nokia.com/privacy.

Welcome to your new Asha smartphone

Here are some things you can try out.

- All that matters on a single screen – Your second home screen is only a swipe away. It shows what you have been up to, and lets you quickly switch between frequently-used apps.
- Beautiful design and vibrant colours – The seamless design ensures your new Asha is built to last, and you can choose a colour that suits your personality.
- Notifications tab – Get instant access to your notifications with a single swipe down, and immediately reply to your missed calls and messages.
- Smart choice – Choose how you wish to connect, be it with a SIM card, Wi-Fi, or Slam.
- Do more online – With your new Asha you can get the most out of your data package, making it faster and easier for you to explore the web.

User Guide

Nokia Asha 501 Dual SIM

Contents

Welcome to your new Asha smartphone	3	Update your status	20
Safety	5	Send a message	20
Get started	6	Set up your mail account	21
Keys and parts	6	Send a mail	22
Insert SIM and battery	6	Chat with your friends	22
Insert a second SIM card (dual SIM only)	7	Internet	24
Insert a memory card	8	Browse the web	24
Charge the battery	9	Add a website to your favourites	24
Lock the keys and screen	9	Camera	26
Set which SIM card to use (dual SIM only)	10	Take a photo	26
Copy contacts from your old phone	10	Record a video	26
Basics	12	Share your photo or video	26
Display indicators	12	Phone management & connectivity	28
Touch screen actions	12	Share your content using Slam	28
Switch between views	14	Connect to a Wi-Fi network	28
Check your activity	14	Copy content between your phone and computer	29
Change settings quickly	15	Update your phone software	29
Reorganise the apps menu	15	Access codes	29
Change your ringtone	16	Product and safety information	32
Add a full keyboard or phone keypad	16		
Add a writing language	16		
Keys on the keyboard	16		
Write using the keyboard	17		
Keys on the keyboard	17		
Write using the keypad	18		
Nokia Store	18		
People & messaging	19		
Make or answer a call	19		
Save a name and phone number	19		
Add social info to contacts	20		

Safety

Read these simple guidelines. Not following them may be dangerous or illegal. For further info, read the complete user guide.



SWITCH OFF IN RESTRICTED AREAS

Switch the device off when mobile phone use is not allowed or when it may cause interference or danger, for example, in aircraft, in hospitals or near medical equipment, fuel, chemicals, or blasting areas. Obey all instructions in restricted areas.



ROAD SAFETY COMES FIRST

Obey all local laws. Always keep your hands free to operate the vehicle while driving. Your first consideration while driving should be road safety.



INTERFERENCE

All wireless devices may be susceptible to interference, which could affect performance.



QUALIFIED SERVICE

Only qualified personnel may install or repair this product.



BATTERIES, CHARGERS, AND OTHER ACCESSORIES

Use only batteries, chargers, and other accessories approved by Nokia for use with this device. Do not connect incompatible products.



KEEP YOUR DEVICE DRY

Your device is not water-resistant. Keep it dry.



PROTECT YOUR HEARING

To prevent possible hearing damage, do not listen at high volume levels for long periods. Exercise caution when holding your device near your ear while the loudspeaker is in use.

Get started

Get to grips with the basics, and have your phone up and running in no time.

Keys and parts

Explore the keys and parts of your new phone.

- 1 Charger connector
- 2 Micro-USB connector
- 3 Headset connector (3.5 mm)
- 4 Volume/Zoom keys
- 5 Lock/Power key
- 6 Microphone
- 7 Back key
- 8 Touch screen
- 9 Camera lens
- 10 Back cover release button
- 11 Antenna area

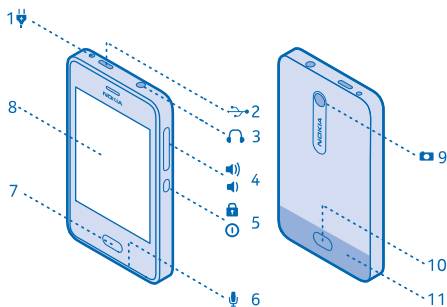

The antenna area is highlighted.

Avoid touching the antenna while the antenna is in use. Contact with antennas affects the communication quality and may reduce battery life due to higher power level during operation.

Insert SIM and battery

Read on to learn how to insert a SIM card and the battery.

1. Press the release button at the back of the phone, and carefully lift and remove the back cover. See 15 on page 31.

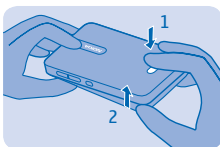

2. If the battery is in the phone, lift it out. See 14 on page 31.

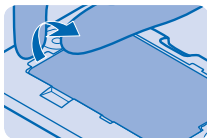

3. Open the SIM holder, and place the SIM in the holder. Make sure the contact area is face down. See 13 on page 31.



4. Line up the battery contacts, and push the battery in.



5. Replace the back cover.

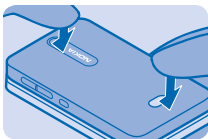

6. To switch on, press and hold the power key until the phone vibrates.

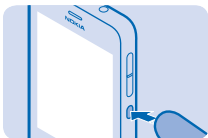

Insert a second SIM card (dual SIM only)

You can easily add a second SIM card (SIM2) without removing the battery.

1. Press the release button at the back of the phone, and carefully lift and remove the back cover.

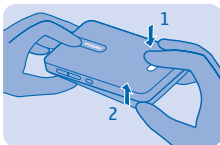

2. Push the SIM in with the contact area face down until it locks into place.

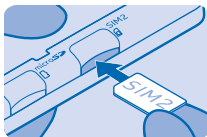

3. To remove the SIM, push the card in until it's released, then pull it out.

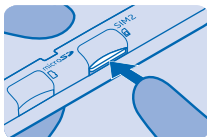

Insert a memory card

Read on to learn how to insert a memory card into your phone.

1. Remove the back cover.

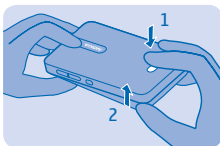

2. Push the card in with the contact area face down until it locks into place. See 6 on page 31.



3. To remove the card, push the card in until it's released. See 7 on page 31.

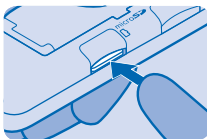

Charge the battery

Your battery has been partially charged at the factory, but you may need to recharge it before you can use your phone.

1. Plug the charger into a wall outlet.

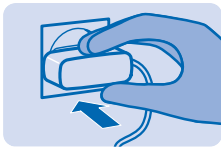

2. Connect the charger to the phone. See 2 on page 31. When done, unplug the charger from the phone, then from the wall outlet.

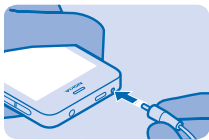

Lock the keys and screen

Lock the keys and screen when not using your phone.

1. Press the power key.

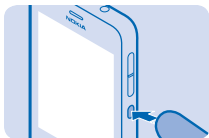

2. To unlock, press the power key, then swipe in from the left or right of the screen.

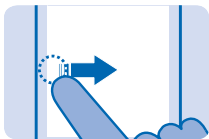

- ★ **Tip:** To wake up the screen, you can also press the back key. If there's a notification from an app on the lock screen, you can swipe over the notification to unlock the phone and open the app.

Set which SIM card to use (dual SIM only)



By default, your phone asks you which SIM to use for the connection. You can also set the default SIM for calls or messaging. If you name your SIMs, you can see at a glance which is, for example, for work or personal use.

Tap  > **Dual SIM**.

1. Switch **Always ask** to  **Off**.
2. Select which SIM to use for which connection.

Availability of SIMs

- If you only have one SIM, put it into the SIM1 holder. Some features may only be available with the SIM in the SIM1 holder.
- When you set one SIM to be used for outgoing calls or messages, or for data connections, the other SIM can still receive calls or messages.
- When one SIM is having an active connection, the other SIM is not available.

Rename SIM

Tap **SIM settings**, and type in the new name under the card you want to name.

Copy contacts from your old phone



Get all your contacts to your new phone in one go.

Your old phone must have Bluetooth, and the contacts must be stored in the phone memory, not on the SIM.

1. On both your new and old phone, switch Bluetooth on, and make sure both phones are visible to others.
2. On your new phone, tap .
3. If you don't have any contacts on your phone yet, tap **Copy contacts** > **Another device**.
4. If you already have contacts on your phone, swipe up from the bottom of the screen, and tap **Copy contacts** > **Copy from** > **Another device**.
5. Move the phones close to each other. When the phones are connected via Bluetooth, the contacts transfer starts.













If your contacts are written in a language that is not supported by your new phone, the contact info may not show correctly.

Basics

Learn how to get the most out of your new phone.

Display indicators

The display indicators on your phone tell you the current time, battery and signal strength, and much more.

-  An alarm is set.
-  The silent profile is on.
-  Battery power level
-  You have new notifications. Swipe down from the top of the screen to see the details.
-  A call is active.
-  Your calls are diverted to another number or your voice mailbox.
-  You have a GSM data connection.
-  You have an EGPRS data connection.
-  Wi-Fi is on.
-  Signal strength
-  Flight mode is on.
-  Bluetooth is on.

The type of mobile network you're currently connected to may be shown with a single letter, a combination of letters, or a combination of letters and numbers. For example, **2G**, depending on your network service provider.

The icons may vary depending on your region or network service provider.

Touch screen actions

Explore your phone with a tap or swipe.

1. To open an app or other item, tap the app or item. See 17 on page 31.

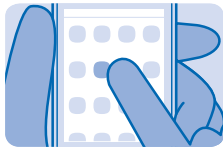

2. To switch a setting on or off, tap the switch.



3. To see more options, tap and hold an item.



4. To swipe, for example, to another home screen, steadily slide your finger left or right.

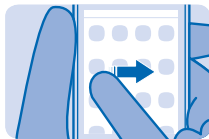

5. To see more options, swipe up from the bottom of the screen if you can see three lines there.



6. To close an app and go back to the home screen, swipe in from the left or right of the screen.



7. To see notifications and change settings, swipe down from the top of the screen. To close the menu, swipe up, or tap an empty area.



8. To scroll through a long list or menu, slide your finger quickly up or down, and lift your finger.

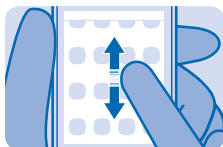

9. To zoom, slide two fingers apart or together on an item.



★ **Tip:** For more info on touch screen actions, see **Tutorial**.

Switch between views

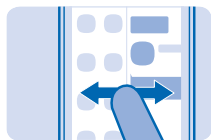

Your phone has two home screens: one for keeping up with your activities, and another one for apps. Swipe left or right to switch between the home screens.

- Easily see what you've been doing lately, and check what's happening next in your calendar.
- In the apps menu, you can open apps. You can rearrange your apps and shortcuts as you like.

Check your activity

Your phone makes it easy for you to always keep up with what's happening.

In the apps menu, swipe left or right to view your activities. Here, you can see the following:

- Apps you've opened recently, grouped by date

- Your upcoming calendar events. Swipe down at the top of the activity list to see what you've got planned next.
- Your latest messages, missed calls, recent music, and more

★ **Tip:** You can easily pause or resume the currently-playing song directly from the list.

★ **Tip:** If you've set up a social networking account, you can post your status update in this screen when you're signed in.

Clear all activity

Tap and hold an item, and tap **Clear all**.

Change settings quickly



Need to quickly switch your phone to silent mode? Rather than going into the phone menus, in most views, you can quickly change some settings and check notifications in the menu that opens from the top of the screen.

1. Swipe down from the top of the screen.

In this screen, you can:

- See your missed calls or unread messages
- Switch all sounds on or off
- Check for Wi-Fi networks, and connect to them
- Switch Bluetooth on or off

2. To close the menu, tap anywhere else on the screen.

Reorganise the apps menu

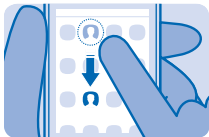

You can organise your apps as you like. Move your favourite apps and shortcuts to the top, or remove shortcuts. You can also uninstall apps you don't need.

1. Tap and hold an item in the apps menu.

2. Drag and drop the item you want to move to a new location. You can move as many items as you like.

3. When you're done, tap the apps menu.

Remove a shortcut

Tap and hold the shortcut, and tap .

Uninstall an app

Tap and hold the app, and tap . You may not be able to uninstall some apps.

Change your ringtone



Set a different ringtone for each SIM card.

1. Tap  > **Sounds and vibra.**
2. Tap **SIM1 ringtone** or **SIM2 ringtone**.
3. Select a ringtone from a list of preloaded tones or from your downloaded music. The ringtone plays so you can see if you like it.
4. When you've found a ringtone you like, tap **Set**.

★ **Tip:** Download more ringtones from Nokia Store. To learn more about Nokia Store, go to www.nokia.com/support.

★ **Tip:** You can also change the message alert tone. Tap **Message tone**, and select a tone.

Add a full keyboard or phone keypad

You can use either the full keyboard or phone keypad when writing.

Tap  > **Writing settings** > **Add keyboards**, and tap the keyboards or keypads you want to use.

Switch between the keyboard and keypad

Swipe left or right on the space key.

This option is available if you have chosen more than one keyboard or keypad.

Add a writing language

Need to write in another language? You can easily switch between several writing languages. In some countries, the languages have been selected by default.

Tap  > **Writing settings** > **Add keyboards** and the language.

Switch between languages when writing

Swipe left or right on the space key.

Keys on the keyboard

The layout of the keyboard may vary, depending on the writing language, input mode, and character range you use.

To start writing, tap a text box.

- 1 Character keys
- 2 Shift key
- 3 Numbers and symbols key
- 4 Space key
- 5 Enter key
- 6 Backspace key

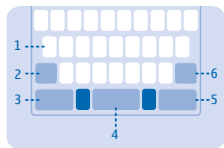

Write using the keyboard

With the keyboard, you can write your messages in no time.

To type in a character, tap the key.

Switch between character cases

Tap ↵.

Add an accent to a character

Tap and hold the character, then tap the accented character you want. This may not be available in all languages.

Switch between number and letter mode

Tap the numbers and symbols key or the letter key.

Type in a special character

Tap the numbers and symbols key, then tap the special character.

Move the cursor to the next row

Tap ↵.

★ **Tip:** Tap and hold the text until you see the cursor. Without lifting your finger, drag the cursor to the place you want.

Delete a character

Tap ☒.

Keys on the keyboard

The layout of the keyboard may vary, depending on the writing language, input mode, and character range you use.

To start writing, tap a text box.

- 1 Character keys
- 2 Shift key
- 3 Space/Language key
- 4 Smiley key
- 5 Enter key
- 6 Symbol key
- 7 Number key
- 8 Backspace key

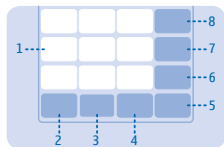

Write using the keypad

Writing with the keypad is easy and fun.

Tap a character key repeatedly until the character is shown. There are more characters available than are shown on the key.

★ **Tip:** To see all the characters found on a character key, tap and hold the key.

Switch between character cases

Tap ⇄.

Switch between number and letter mode

Tap the number key or the letter key.

Type in a special character

Tap the symbol key, then tap the special character.

Move the cursor to the next row

Tap ↵.

★ **Tip:** Tap and hold the text until you see the cursor. Without lifting your finger, drag the cursor to the place you want.

Delete a character

Tap ☒. If it's a compound character, tap the key repeatedly until the character is removed. Compound characters are not available in all languages.

Nokia Store



Download mobile games, apps, themes, wallpapers, and ringtones to your phone from Nokia Store.

Select .

Many items are free of charge; some you need to pay for with your credit card or on your phone bill.

The availability of payment methods depends on your country of residence and your network service provider.



To learn more about Nokia Store, go to store.ovi.com.

People & messaging

Contact your friends and family, and share files, such as photos, using your phone. Stay tuned with the latest updates to your social networking services even when on the go.

Make or answer a call

Learn how to make or answer a call with your new phone.

1. Tap .
2. Type in the phone number.
To type in the + character, used for international calls, tap * twice.
3. Tap . If asked, select which SIM to use.
4. To end the call, tap .
5. When someone calls you, swipe down to answer.

★ **Tip:** Is your friend's voice too loud or quiet? Press the volume keys to change the volume.

Swap between calls

Tap .

Decline a call

Swipe up, and tap .

Silence a call

When someone calls you, swipe up.

★ **Tip:** After silencing the call, you can quickly send a text message. Tap , and write your message.

Call last dialed number

On the activity screen, tap the contact name or phone number you called, and tap .

View your missed calls

If you missed a call, a notification is shown on the lock screen. Swipe over the notification to see the call info. Tap  to call back.

Missed and received calls are logged only if supported by the network, and the phone is switched on and within the network service area.

★ **Tip:** To view missed calls later, tap  >  > **Missed**.

Save a name and phone number



Add new contacts to your phone.

1. Tap .
2. Swipe up from the bottom of the screen, and tap **Add new contact**.
3. Write the name, number, and other details.

★ **Tip:** To save a phone number in the dialler, type in the number, and tap .

Edit the details of a contact

Tap the contact, and swipe up from the bottom of the screen. Then tap **Edit**, and edit the details, such as the mail address or ringtone.

Add more details

When editing a contact, swipe up from the bottom of the screen, tap **Add details**, and tap a detail.

Add social info to contacts

Sign in to social networking services to add your friends' info to your phone contacts list.

1. Tap .
2. Swipe up from the bottom of the screen, and tap **Accounts**.
3. Tap an account, and sign in.
4. Tap **Contacts**, and select which contacts you want to bring to your contacts list.
5. Tap **Done**.

Info from the account shows up in your contacts list.

Update your status

When you're signed in to your Nokia account and social networking services, you can post your status update on the home screen showing your recent activity.

1. To go to the home screen showing your recent activity, swipe in from the left of the screen until you get there.
2. Tap the text input box, and write your status message.
3. Tap .

The social networking services are third-party services and not provided by Nokia. Check the privacy settings of the social networking service you are using as you may share info with a large group of people. The terms of use of the social networking service apply to sharing info on that service. Familiarise yourself with the terms of use and the privacy practices of that service.

Send a message



With text and multimedia messages, you can quickly contact your friends and family.

1. Tap  > .

2. To add a contact as a recipient, tap **+**, or tap **Add recipient** to start writing a name or typing in a phone number. You can add more than one recipient.

3. Write your message in the text box.

★ **Tip:** To add a smiley, tap 😊.

4. To add an attachment, such as a photo or video, tap 📎.

★ **Tip:** You can also take a new photo while writing your message. Tap 📷 > **Camera**, take a photo, and tap **Done**.

5. Tap 📶. If asked, select which SIM to use.

See 10 on page 31, 11 on page 31, and 9 on page 31.

Set up your mail account

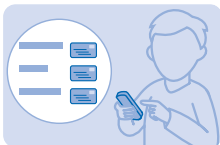

Do you use more than one mail address? You can have several mailboxes on your phone.

You must be connected to the internet to add a mailbox.

1. Tap @ > **+**.

2. Tap **+** and a mail account.

3. Write your username and password.

4. Tap **Sign in**.

Add a mailbox later

Tap @, swipe up from the bottom of the screen, and tap **Accounts**. Then tap **+** and an account, and sign in.

Switch off the automatic update of the inbox

Tap 🔄 and an account. Then tap **Update Inbox**, and change the setting, if needed.

Your phone updates your inbox at certain intervals to show your new mails when they have arrived. This may cause transfer of large amounts of data, which may result in data traffic costs. To save costs, you can switch the automatic update feature off and update your inbox manually using a Wi-Fi connection.

Delete a mailbox

Tap 🔄, tap and hold the account, and tap **Delete**.

Send a mail

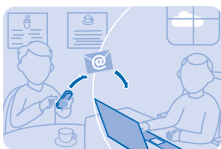

Would you like to send a mail while on the go? With your phone, you can read and send mail, even when not sitting at your desk.

You must be connected to the internet to send and receive mail.

1. Tap **@** and a mail account.
2. Swipe up from the bottom of the screen, and tap **Compose email**.
3. To add a recipient, tap **+**, or start writing a name. You can also write the address.
4. Write the subject and your message.

★ **Tip:** To add a suggested word, tap it. To browse the list, swipe over the suggestions. If you don't want to use this feature, swipe up from the bottom of the screen, and switch **Prediction** to **Off**.

5. To add an attachment, such as a photo, swipe down to close the keyboard, then swipe up from the bottom of the screen, and tap **Add attachment**.

★ **Tip:** You can also take a new photo while writing your mail. Tap  >  > , take a photo, and tap **Done**.

6. Tap **Send**.

Read a mail

You can see on the activity screen when you've received new mail. Swipe down from the top of the screen, and tap the mail notification.

Chat with your friends



Do you like chatting online with your friends? If you are out, you can send instant messages with your phone no matter where you are.

You must be connected to the internet to chat.

You need a Nokia account to chat. If you don't have one, you can create a new account during setup. Tap **@**, type in your username and password, and sign in.

If you have added friends to your chat contacts, they are automatically included in your contacts. If you have no contacts yet, you are asked to invite friends to chat. You can also chat with others than just your chat contacts.

1. Tap .
2. To start a chat, tap a contact. Green colour indicates that your friend is online.
3. Write your message.

★ **Tip:** To add a smiley, tap .

4. Tap .

Using services or downloading content may cause the transfer of large amounts of data, which may result in data costs.

Internet

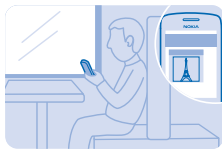

Learn how to create wireless connections and browse the web while keeping your data costs down.

Browse the web



Catch up on the news, and visit your favourite websites on the go.

- ★ **Tip:** If your network service provider doesn't charge you a fixed fee for data transfer, to save on data costs, use a Wi-Fi network to connect to the internet.

1. Tap .
2. Write the web address in the address bar, and tap .

- ★ **Tip:** To search the internet, write a search word in the address bar. If asked, select your default search engine.

Zoom in or out

Place two fingers on the screen, and slide your fingers apart or together.

- ★ **Tip:** To view the page in a single column of larger, readable text and pictures without having to zoom in, swipe up from the bottom of the screen, tap **More > Settings**, and switch **Column view** to **On** .

Share a web page

When browsing, swipe up from the bottom of the screen, and tap **Share** and how you want to share.

- ★ **Tip:** Follow your data usage with the Counters app.

Add a website to your favourites



If you visit the same websites all the time, add them to your favourites so you can easily access them.

1. Tap .
2. While browsing, swipe up from the bottom of the screen, and tap **Add to favourites**.

Go to a favourite website

Swipe up from the bottom of the screen, tap **Favourites** and a favourite.

- ★ **Tip:** You can also pin your favourite websites to the apps menu. While browsing, swipe up from the bottom of the screen, and tap **Add to Home**.



Camera

Why carry a separate camera if your phone has all you need for capturing memories? With your phone camera, you can easily take photos or record videos.

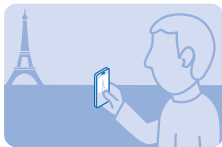
Take a photo



Capture the best moments with your phone camera.





1. To switch the camera on, tap .
2. To zoom in or out, place two fingers on the screen, and slide them apart or together. You can also use the volume keys.
3. To take a photo, tap .

The photos are saved in .

Record a video



Besides taking photos, you can also record videos with your phone.

1. To switch the video camera on, tap  > .
2. You can also use the volume keys.
3. To start recording, tap .
4. To stop recording, tap .

Videos are saved in .

★ **Tip:** You can send your video in a multimedia or mail message. To limit the video size for sending, in video camera, before recording, tap the settings area, and switch **Video quality** to **Low**.

Share your photo or video

Let others admire your great shots. Send them to your friends or share them on a social networking service.

1. Tap .
2. Tap the photo or video and .

3. Select how to share, and follow the instructions shown on the screen.

★ **Tip:** You can also share photos or videos directly from the camera, right after taking them. Tap  > .

Not all sharing services support all file formats or videos recorded in high quality.

Using services or downloading content may cause the transfer of large amounts of data, which may result in data costs.

Phone management & connectivity

Take care of your phone and its contents. Learn how to connect to accessories and networks, transfer files, create backups, lock your phone, and keep the software up to date.

Share your content using Slam



Share your content easily with Slam.

1. Switch Bluetooth on in both phones.
2. Make sure the phones are visible to other phones.
3. Tap, for example, a photo, and  **Slam via Bluetooth**.
4. Move your phone close to the other phone.

Slam searches for the nearest phone, and sends the item to it. See 3 on page 31.

Connect to a Wi-Fi network



To help save on data costs, you can use a Wi-Fi network to connect to the internet, whether you're at home or at a library or internet café.

1. Swipe down from the top of the screen, and tap .
2. Tap **Wi-Fi** and the network you want.
3. If the connection is secured, type in the password.

Connect to the previously used Wi-Fi network

Swipe down from the top of the screen, and tap .

Add a new network

Make sure Wi-Fi is on, tap **Add new network**, and type in the required info.

Close the Wi-Fi connection

Swipe down from the top of the screen, and tap .

Copy content between your phone and computer

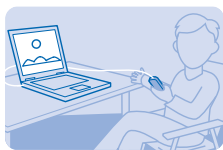

Copy photos, videos, music, and other content created by you (and stored on the memory card) between your phone and computer.

To copy content from the phone memory, you need to have a memory card inserted in your phone.

1. Connect your phone to a compatible computer with a compatible USB cable.
2. Tap **Mass storage**.
3. On your computer, open a file manager, such as Windows Explorer, and browse to your phone. You can see the content stored on the memory card.
4. Drag and drop items between your phone and computer.

Update your phone software

Stay in step with the beat – update your phone software and apps to get new and enhanced features for your phone. You can also set your phone to automatically check for updates.

You can only update your phone software when using the SIM in the SIM1 holder.

1. Tap  > **Phone update**.

★ **Tip:** To quickly go to updates, when your phone notifies you of an update, swipe down from the top of the screen, and tap the update notification.

2. To download and install an update, tap **Update**, and follow the instructions shown on the phone.

The update may take several minutes. If you encounter problems, contact your network service provider.

After the update, go to www.nokia.com/support to get your new user guide.

Your network service provider may send updates over the air directly to your phone. For more info on this network service, contact your network service provider.

See 8 on page 31, 4 on page 31, 5 on page 31.

Access codes

Ever wondered what the different codes on your phone are for?

PIN or PIN2 code
(4–8 digits)

These protect your SIM card against unauthorised use or are required to access some features.







You can set your phone to ask for the PIN code when you switch it on.

	<p>If not supplied with your card or you forget the codes, contact your network service provider.</p> <p>If you type in the code incorrectly three times in a row, you need to unblock the code with the PUK or PUK2 code.</p>
PUK or PUK2	<p>These are required to unblock a PIN or PIN2 code.</p> <p>If not supplied with your SIM card, contact your network service provider.</p>
Security code (lock code, password)	<p>This helps you protect your phone against unauthorised use.</p> <p>You can set your phone to ask for the lock code that you define.</p> <p>Keep the code secret and in a safe place, separate from your phone.</p> <p>If you forget the code and your phone is locked, your phone will require service. Additional charges may apply, and all the personal data in your phone may be deleted.</p> <p>For more information, contact Nokia Care or your phone dealer.</p>
IMEI	<p>This is used to identify valid phones in the network. The number can also be used to block, for example, stolen phones. You may also need to give the number to Nokia Care services.</p> <p>To view your IMEI number, dial *#06#.</p>

Feature-specific information

- 1 The images in this guide may differ from your device screen.
- 2 If the battery is completely discharged, it may take several minutes before the charging indicator is displayed or before any calls can be made.
- 3 Operating the device in hidden mode is a safer way to avoid malicious software. Do not accept Bluetooth connection requests from sources you do not trust. You can also switch the Bluetooth function off when you are not using it.
- 4 Before starting the update, connect a charger or make sure the device battery has enough power.
- 5  **Warning:** If you install a software update, you cannot use the device, even to make emergency calls, until the installation is completed and the device is restarted.



- 6 Use only compatible memory cards approved for use with this device. Incompatible cards may damage the card and the device and corrupt data stored on the card.
- 7  **Important:** Do not remove the memory card when an app is using it. Doing so may damage the memory card and the device and corrupt data stored on the card.
- 8 Using services or downloading content may cause the transfer of large amounts of data, which may result in data costs.
- 9 You can send text messages that are longer than the character limit for a single message. Longer messages are sent as two or more messages. Your service provider may charge accordingly. Characters with accents, other marks, or some language options, take more space, and limit the number of characters that can be sent in a single message.
- 10 If the item you insert in a multimedia message is too large for the network, the device may automatically reduce the size.
- 11 Only compatible devices can receive and show multimedia messages. Messages may look different in different devices.
- 12 Do not connect products that create an output signal, as this may damage the device. Do not connect any voltage source to the audio connector. If you connect an external device or headset, other than those approved for use with this device, to the audio connector, pay special attention to volume levels.
- 13  **Important:** This device is designed to be used with a mini-UICC SIM card, also known as a micro-SIM card only. A micro-SIM card is smaller than the standard SIM card. Use of incompatible SIM cards, or use of SIM card adapters, may damage the card or the device, and may corrupt data stored on the card.
- 14  **Important:** To prevent damage to the SIM card, always remove the battery before you insert or remove the card. Only applies to SIM1.
- 15  **Note:** Switch the device off and disconnect the charger and any other device before removing any covers. Avoid touching electronic components while changing any covers. Always store and use the device with any covers attached.
- 16 The social networking services are third-party services and not provided by Nokia. Check the privacy settings of the social networking service you are using as you may share info with a large group of people. The terms of use of the social networking service apply to sharing info on that service. Familiarise yourself with the terms of use and the privacy practices of that service.
- 17  **Important:** Avoid scratching the touch screen.
- 18 Nokia does not provide a warranty for or take any responsibility for the functionality, content, or end-user support of third-party apps provided with your device. By using an app, you acknowledge that the app is provided as is. Nokia does not make any representations, provide a warranty, or take any responsibility for the functionality, content, or end-user support of third-party apps provided with your device.
- 19  **Important:** Use encryption to increase the security of your Wi-Fi connection. Using encryption reduces the risk of others accessing your data.

Product and safety information

Network services and costs



You can only use your device on the GSM 900 and 1800 MHz networks. You need a subscription with a service provider.

Using some features and downloading content require a network connection and may result in data costs. You may also need to subscribe to some features.

Emergency calls

1. Make sure the device is switched on.
2. Check for adequate signal strength.

You may also need to do the following:

- Put a SIM card in the device.
 - Switch the call restrictions off in your device, such as call barring, fixed dialling, or closed user group.
 - Make sure the flight profile is not activated.
 - If the device screen and/or keys are locked, unlock them.
3. Press the back key repeatedly, until the home screen is shown.
 4. To open the dialler, select .
 5. Type in the official emergency number for your present location. Emergency call numbers vary by location.
 6. Select .
 7. Give the necessary info as accurately as possible. Do not end the call until given permission to do so.

When you switch your device on for the first time, you are asked to create your Nokia account. To make an emergency call during the account setup, press the menu key.

-  **Important:** Activate both cellular and internet calls, if your phone supports internet calls. The phone may attempt to make emergency calls both through cellular networks and through your internet call service provider. Connections in all conditions cannot be guaranteed. Never rely solely on any wireless phone for essential communications like medical emergencies.

Take care of your device

Handle your device, battery, charger and accessories with care. The following suggestions help you keep your device operational.

- Keep the device dry. Precipitation, humidity, and all types of liquids or moisture can contain minerals that corrode electronic circuits. If your device gets wet, remove the battery, and let the device dry.
- Do not use or store the device in dusty or dirty areas.
- Do not store the device in high temperatures. High temperatures may damage the device or battery.
- Do not store the device in cold temperatures. When the device warms to its normal temperature, moisture can form inside the device and damage it.
- Do not open the device other than as instructed in the user guide.
- Unauthorised modifications may damage the device and violate regulations governing radio devices.
- Do not drop, knock, or shake the device. Rough handling can break it.
- Only use a soft, clean, dry cloth to clean the surface of the device.
- Do not paint the device. Paint can prevent proper operation.
- For optimal performance, switch the device off and remove the battery from time to time.
- Keep the device away from magnets or magnetic fields.
- To keep your important data safe, store it in at least two separate places, such as your device, memory card, or computer, or write down important info.

Recycle



Always return your used electronic products, batteries, and packaging materials to dedicated collection points. This way you help prevent uncontrolled waste disposal and promote the recycling of materials. All materials of the device can be recovered as materials and energy. Check how to recycle your Nokia products at www.nokia.com/recycle.

Crossed-out wheeled-bin symbol



The crossed-out wheeled-bin symbol on your product, battery, literature, or packaging reminds you that all electrical and electronic products and batteries must be taken to separate collection at the end of their working life. Do not dispose of these products as unsorted municipal waste: take them for recycling. For info on your nearest recycling point, check with your local waste authority, or go to www.nokia.com/support. For more info on the environmental attributes of your device, see www.nokia.com/ecoprofile.

About Digital Rights Management

When using this device, obey all laws and respect local customs, privacy and legitimate rights of others, including copyrights. Copyright protection may prevent you from copying, modifying, or transferring photos, music, and other content.

Digital rights management (DRM) protected content comes with an associated licence that defines your rights to use the content.

With this device you can access content protected with OMA DRM 1.0. If certain DRM software fails to protect the content, content owners may ask that such DRM software's ability to access new DRM-protected content be revoked. Revocation may also prevent renewal of such DRM-protected content already in your device. Revocation of such DRM software does not affect the use of content protected with other types of DRM or the use of non-DRM-protected content.

Battery and charger info

Use your device only with an original BL-4U rechargeable battery. Nokia may make additional battery models available for this device.

Charge your device with AC-11 charger. Charger plug type may vary.

The battery can be charged and discharged hundreds of times, but it will eventually wear out. When the talk and standby times are noticeably shorter than normal, replace the battery.

! **Important:** Talk and standby times are estimates only. Actual times are affected by, for example, network conditions, device settings, features being used, battery condition, and temperature.

Battery and charger safety

Always switch the device off and unplug the charger before removing the battery. To unplug a charger or an accessory, hold and pull the plug, not the cord.

When your charger is not in use, unplug it. If left unused, a fully charged battery will lose its charge over time.

Always keep the battery between 15°C and 25°C (59°F and 77°F). Extreme temperatures reduce the capacity and lifetime of the battery. A device with a hot or cold battery may not work temporarily.

Accidental short-circuiting can happen when a metallic object touches the metal strips on the battery. This may damage the battery or the other object.

Do not dispose of batteries in a fire as they may explode. Obey local regulations. Recycle when possible. Do not dispose as household waste.

Do not dismantle, cut, crush, bend, puncture, or otherwise damage the battery in any way. If a battery leaks, do not let liquid touch skin or eyes. If this happens, immediately flush the affected areas with water, or seek medical help. Do not modify, attempt to insert foreign objects into the battery, or immerse or expose it to water or other liquids. Batteries may explode if damaged.

Use the battery and charger for their intended purposes only. Improper use, or use of unapproved or incompatible batteries or chargers may present a risk of fire, explosion, or other hazard, and may invalidate any approval or warranty. If you believe the battery or charger is damaged, take it to a service centre before continuing to use it. Never use a damaged battery or charger. Only use the charger indoors.

Additional safety information

Small children

Your device and its accessories are not toys. They may contain small parts. Keep them out of the reach of small children.

Medical devices

Operation of radio transmitting equipment, including wireless phones, may interfere with inadequately shielded medical devices' function. Consult a physician or the medical device's manufacturer to determine if it is adequately shielded from external radio energy.

Implanted medical devices

To avoid potential interference, manufacturers of implanted medical devices recommend a minimum separation of 15.3 centimetres (6 inches) between a wireless device and the medical device. Persons who have such devices should:

- Always keep the wireless device more than 15.3 centimetres (6 inches) from the medical device.
- Not carry the wireless device in a breast pocket.
- Hold the wireless device to the ear opposite the medical device.
- Switch the wireless device off if there is any reason to suspect that interference is taking place.
- Follow the manufacturer directions for the implanted medical device.

If you have any questions about using your wireless device with an implanted medical device, consult your health care provider.

Accessibility solutions

Nokia is committed to making mobile phones easy to use for all individuals, including those with disabilities. For more information, visit the Nokia website at www.nokiaaccessibility.com.

Hearing

 **Warning:** When you use the headset, your ability to hear outside sounds may be affected. Do not use the headset where it can endanger your safety.

Some wireless devices may interfere with some hearing aids.

Nickel

The surface of this device is nickel-free.

Protect your device from harmful content

Your device may be exposed to viruses and other harmful content. Take the following precautions:

- Be cautious when opening messages. They may contain malicious software or otherwise be harmful to your device or computer.
- Be cautious when accepting connectivity requests, browsing the internet, or downloading content. Do not accept Bluetooth connections from sources you do not trust.
- Only install and use services and software from sources that you trust and that offer adequate security and protection.
- Install antivirus and other security software on your device and any connected computer. Only use one antivirus app at a time. Using more may affect performance and operation of the device and/or computer.
- If you access preinstalled bookmarks and links to third party internet sites, take the appropriate precautions. Nokia does not endorse or assume liability for such sites.

Operating environment

This device meets radio frequency exposure guidelines in the normal use position at the ear or at least 1.5 centimetres (5/8 inch) away from the body. Any carry case, belt clip, or holder for body-worn operation should not contain metal and should position the device the above-stated distance from your body.

The sending of data files or messages requires a quality network connection and may be delayed until such a connection is available. Follow the separation distance instructions until the sending is completed.

Parts of the device are magnetic. Metallic materials may be attracted to the device. Do not place credit cards or other magnetic storage media near the device, because information stored on them may be erased.

Vehicles

Radio signals may affect improperly installed or inadequately shielded electronic systems in vehicles. For more info, check with the manufacturer of your vehicle or its equipment.

Only qualified personnel should install the device in a vehicle. Faulty installation may be dangerous and invalidate your warranty. Check regularly that all wireless device equipment in your vehicle is mounted and operating properly. Do not store or carry flammable or explosive materials in the same compartment as the device, its parts, or accessories. Do not place your device or accessories in the air bag deployment area.

Potentially explosive environments

Switch your device off in potentially explosive environments, such as near petrol pumps. Sparks may cause an explosion or fire resulting in injury or death. Note restrictions in areas with fuel; chemical plants; or where blasting operations are in progress. Areas with a potentially explosive environment may not be clearly marked. These usually are areas where you are advised to switch your engine off, below deck on boats, chemical transfer or storage facilities, and where the air contains chemicals or particles. Check with the manufacturers of vehicles using liquefied petroleum gas (such as propane or butane) if this device can be safely used in their vicinity.

Certification information (SAR)

This mobile device meets guidelines for exposure to radio waves.

Your mobile device is a radio transmitter and receiver. It is designed not to exceed the limits for exposure to radio waves recommended by international guidelines. These guidelines were developed by the independent scientific organisation ICNIRP and include safety margins designed to assure the protection of all persons, regardless of age and health.

The exposure guidelines for mobile devices employ a unit of measurement known as the Specific Absorption Rate or SAR. The SAR limit stated in the ICNIRP guidelines is 2.0 watts/kilogram (W/kg) averaged over 10 grams of tissue. Tests for SAR are conducted using standard operating positions with the device transmitting at its highest certified power level in all tested frequency bands. The actual SAR level of an operating device can be below the maximum value because the device is designed to use only the power required to reach the network. That amount changes depending on a number of factors such as how close you are to a network base station.

The highest SAR value under the ICNIRP guidelines for use of the device at the ear is 0.96 W/kg. Use of device accessories may result in different SAR values. SAR values may vary depending on national reporting and testing requirements and the network band. Additional SAR information may be provided under product information at www.nokia.com.

All Nokia products comply with international and, where adopted, country specific standards and guidelines for limiting human exposure to electromagnetic fields. These international standards and guidelines were adopted after thorough reviews of the science. Those reviews do not establish a link between the use of mobile devices and adverse health effects when the device is operating within the international standards and guidelines. We are required by the India Department of Telecommunications to include in this user guide the following guidance on precautionary measures:

You can limit exposure to radio frequency energy by either using the device in good reception conditions or using a hands-free kit (e.g., Bluetooth headset, wired headset, internal loudspeaker, etc). A further precautionary measure especially for children, pregnant women and adolescents would be to keep calls short and consider sending a text message (e.g., SMS) instead. You should always ensure that the SAR value of your mobile device is below the limit set by the India Department of Telecommunications. Information about the SAR level of Nokia devices sold in India can be obtained from Nokia's website at www.nokia.com.

Your mobile device is also designed to meet the requirements for exposure to radio waves established by the India Department of Telecommunications. These requirements set a SAR limit of 1.6 W/kg averaged over one gram of tissue. The highest SAR value reported under this standard during product certification for use at the ear is 1.41 W/kg.

Nokia original accessories

For availability of approved accessories, check with your dealer.

An extensive range of accessories is available for your device. For more details, see www.nokia.com/accessories.

Practical rules about accessories

- Keep all accessories out of the reach of small children.
- When you disconnect the power cord of any accessory, grasp and pull the plug, not the cord.
- Check regularly that accessories installed in a vehicle are mounted and are operating properly.
- Installation of any complex car accessories must be made by qualified personnel only.

Battery

Type: BL-4U

Talk time:

Up to 17 hours.

Standby:

Up to 26 days.

- !** **Important:** Battery talk and stand-by times are estimates and only possible under optimal network conditions. Actual battery talk and standby times depend on SIM cards, features used, battery age and condition, temperatures to which battery is exposed, network conditions, and many other factors, and may be significantly shorter than those specified above. Ringing tones, hands free call handling, use in digital mode, and other features will also consume the battery, and the amount of time a device is used for calls will affect its stand-by time. Likewise, the amount of time that the device is turned on and in the standby mode will affect its talk time.

Nokia support messages

To help you take maximum advantage of your phone and services, you receive free customised text messages from Nokia. The messages contain tips and tricks and support.

To stop receiving the messages, select  > **Nokia account** > **Get news and offers**.

To provide the service described above, your mobile phone number, the serial number of your phone, and some identifiers of the mobile subscription are sent to Nokia when you use the phone for the first time. Some or all information may also be sent to Nokia when updating software. This information may be used as specified in the privacy policy, available at www.nokia.com.

Copyrights and other notices

DECLARATION OF CONFORMITY

CE 0168

Hereby, NOKIA CORPORATION declares that this RM-902 product is in compliance with the essential requirements and other relevant provisions of Directive 1999/5/EC. A copy of the Declaration of Conformity can be found at www.nokia.com/global/declaration/declaration-of-conformity.

The availability of products, features, apps and services may vary by region. For more info, contact your Nokia dealer or your service provider. This device may contain commodities, technology or software subject to export laws and regulations from the US and other countries. Diversion contrary to law is prohibited.

The contents of this document are provided "as is". Except as required by applicable law, no warranties of any kind, either express or implied, including, but not limited to, the implied warranties of merchantability and fitness for a particular purpose, are made in relation to the accuracy, reliability or contents of this document. Nokia reserves the right to revise this document or withdraw it at any time without prior notice.

To the maximum extent permitted by applicable law, under no circumstances shall Nokia or any of its licensors be responsible for any loss of data or income or any special, incidental, consequential or indirect damages howsoever caused.

Reproduction, transfer or distribution of part or all of the contents in this document in any form without the prior written permission of Nokia is prohibited. Nokia operates a policy of continuous development. Nokia reserves the right to make changes and improvements to any of the products described in this document without prior notice.

Reverse engineering of software in the device is prohibited to the extent permitted by applicable law. Insofar as this user guide contains any limitations on Nokia's representations, warranties, damages and liabilities, such limitations shall likewise limit any representations, warranties, damages and liabilities of Nokia's licensors.

Nokia does not provide a warranty for or take any responsibility for the functionality, content, or end-user support of third-party apps provided with your device. By using an app, you acknowledge that the app is provided as is. Nokia does not make any representations, provide a warranty, or take any responsibility for the functionality, content, or end-user support of third-party apps provided with your device.

Downloading of maps, games, music and videos and uploading of images and videos may involve transferring large amounts of data. Your service provider may charge for the data transmission. The availability of particular products, services and features may vary by region. Please check with your local Nokia dealer for further details and availability of language options.

TM & © 2013 Nokia. All rights reserved. Third party products/names may be TMs of their respective owners.

The Bluetooth word mark and logos are owned by the Bluetooth SIG, Inc. and any use of such marks by Nokia is under license.



Oracle and Java are registered trademarks of Oracle and/or its affiliates.

This product is licensed under the MPEG-4 Visual Patent Portfolio License (i) for personal and noncommercial use in connection with information which has been encoded in compliance with the MPEG-4 Visual Standard by a consumer engaged in a personal and noncommercial activity and (ii) for use in connection with MPEG-4 video provided by a licensed video provider. No license is granted or shall be implied for any other use. Additional information, including that related to promotional, internal, and commercial uses, may be obtained from MPEG LA, LLC. See www.mpegla.com.

In the event of any inconsistencies between the English language version and any Indic language translation, the English language version shall always prevail over the Indic language translation.